



# D4E146 Series Centrifugal Blower

Ø 146mm

- AC dual inlet, forward curved centrifugal blower. Via a bracket, the integrated external-rotor motor is mounted on one side of the housing.
- Direction of rotation is CCW as seen from inlet opposite the cable exit. Insulation class "B".
- Housing and impeller made of galvanised sheet-steel. Forward curved impellers are directly press-fitted onto the rotor of the external-rotor motor.
- Maintenance-free ball bearings.
- UL, CSA, VDE approvals on some models, please contact application engineering.

Part Number	Curve	CFM @ 0	VAC	Hertz	Power (W)	dBA	Max Amb. Temp. C	Bearing Type	Features	Capacitor (µF)	Wgt. (lbs)
D4E146-AA25-34	1	450	115	60	128	55	60	Ball	Leads	8	7.69
D4E146-AA07-22	1	450	230	50/60	116	53	60	Ball	Leads	2	7.69

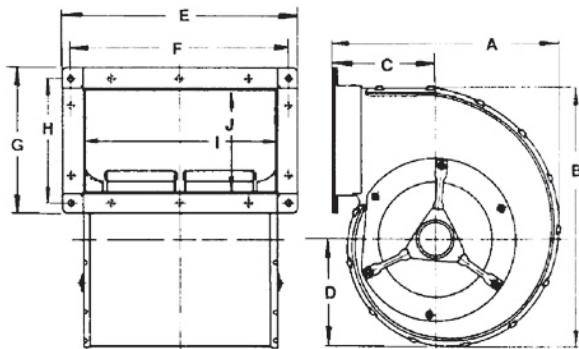

DIMENSIONS - Inches (mm)

PART NUMBER	A	B	C	D	E	F	G	H	I	J
D2E146-AA	8.11	8.62	3.82	3.86	10.63	10.0	5.59	4.96	9.13	4.02
	(206)	(219)	(97)	(98)	(270)	(254)	(142)	(126)	(232)	(102)

